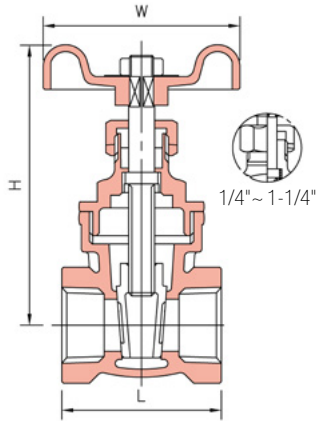

FIG 41



序號 NO.	零件	PART	材 質 MATERIAL
1	閥 體	BODY	CAST BRASS
2	閥 蓋	BONNET	CAST BRASS
3	閥 門	DISC	CAST BRASS
4	閥 桿	STEM	BRASS
5	迫緊螺帽	PACKING NUT	BRASS
6	迫 緊	PACKING	PTFE/NBR
7	格 南	GLAND	1-1/2"~ 4" BRASS
8	手 輪	HANDWHEEL	ALUMINUM
9	銘 牌	NAME PLATE	ALUMINUM
10	閥桿套	HINGE PIN	BRASS
11	螺 帽	HANDWHEEL NUT	STEEL

Features

- Non-Rising Stem
- Full Ports
- Screwed Bonnet
- Integral Seat
- Solid Wedge Disc
- CNS-9805 台正字第 6105 號
- Threaded Ends

Working Pressure Non-Shock 最高工作壓力 (靜流水)		Hydrostatic Test Pressure 試驗壓力 (水壓)		
Steam, Water, Oil or Gas 蒸汽 . 水 . 油或氣體	125 psi	Shell Test Pressure 閥體測試壓力	Air 氣壓 80 psi	Water 水壓 300 psi
Cold Working Pressure 常溫工作壓力	200 psi	Seat Test Pressure 閥座測試壓力	80 psi	200 psi

詳細尺寸 Dimension

單位 Unit: 公釐 mm

規格	3/8"	1/2"	3/4"	1"	1-1/4"	1-1/2"	2"	2-1/2"	3"	4"
Size	10	15	20	25	32	40	50	65	80	100
L	40	43	47	53	60	62	70	87	95	113
H	75	75	83	96	111	120	162	173	213	260
W	55	55	55	58	70	74	90	105	110	132

FIG 51

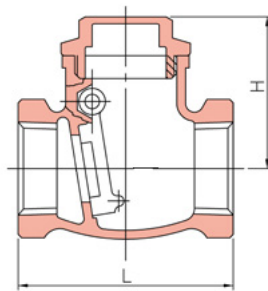

序號 NO.	零件	PART	材 質 MATERIAL
1	閥 體	BODY	CAST BRASS
2	閥 蓋	CAP	CAST BRASS
3	閥 門	DISC	CAST BRASS
4	銷	PIN	BRASS
5	堵 頭	PLUG	BRASS

Features

- T-Type Body
- Threaded Ends
- Swing Disc
- CNS-9804 台正字第 6104 號
- Screwed Cap

Working Pressure Non-Shock 最高工作壓力 (靜流水)		Hydrostatic Test Pressure 試驗壓力 (水壓)		
Steam, Water, Oil or Gas 蒸汽 . 水 . 油或氣體	125 psi	Shell Test Pressure 閥體測試壓力	Air 氣壓 80 psi	Water 水壓 300 psi
Cold Working Pressure 常溫工作壓力	200 psi	Seat Test Pressure 閥座測試壓力	80 psi	200 psi

詳細尺寸 Dimension

單位 Unit: 公釐 mm

規格	1/2"	3/4"	1"	1-1/4"	1-1/2"	2"	2-1/2"	3"	4"
Size	15	20	25	32	40	50	65	80	100
L	54	59	69	79	89	109	135	150	180
H	37	40	46	57	63	68	81	91	110