

FORGED STEEL
INTEGRAL FLANGED CHECK VALVES
JIS 10K/20K

FIG.FX63A Series

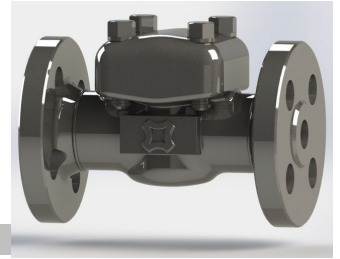

Bill of Materials & Parts

Part No.	Part Name	QTY	ASTM Specifications (Specs.-Grades/Types)											
			A105	A350	A182									
				LF2	F11	F22	F5	F9	F304	F304L	F316	F316L		
1	BODY (SEAT) *	1	A105+STLT	A350-LF2+STLT	A182-F11+STLT	A182-F22+STLT	A182-F5+STLT	A182-F9+STLT	A182-F304+STLT	A182-F304L+STLT	A182-F316+STLT	A182-F316L+STLT		
2	BONNET	1	A105	A350-LF2	A182-F11	A182-F22	A182-F5	A182-F9	A182-F304	A182-F304L	A182-F316	A182-F316L		
3	DISC *	1	A276-420+STLT						A276-304+STLT	A276-304L+STLT	A276-316+STLT	A276-316L+STLT		
4	GASKET	1	GRAFOIL 316L SPIRAL WOUND											
5	NAME PLATE	1	STAINLESS STEEL											
6	SPRING	1	CRES											
7	BONNET BOLT	1	A193-B7			A193-B16			A193-B7					
9	END COVER	2	PE											

NOTE : (1) Integral Flanged Body. (2) *Stellite Hard Faced. (3) Other Materials Also Available on Requested. (4) KING GATE Reserves The Right To Change Designs , Materials or Specifications Without Notice.

Unit : mm

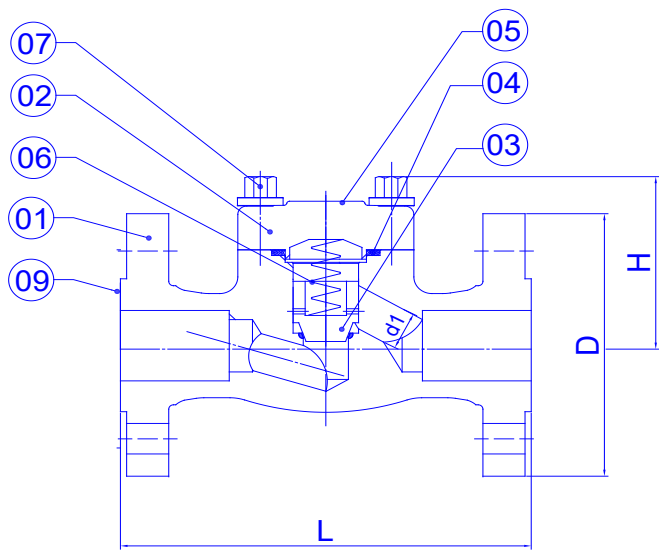

JIS 10K					
SIZE	d1	D	L	H [OPEN]	Wts.-kg [APPROX.]
1/2"	10.00	90.0	108.00	61.0	2.8
3/4"	13.00	100.0	118.00	63.0	3.6
1"	17.50	110.0	127.00	78.0	5.1
1-1/4"	28.00	117.0	140.00	82.0	9.5
1-1/2"	28.00	127.0	165.00	88.0	9.7
2"	36.00	152.0	203.00	108.0	14.9

JIS 20K					
SIZE	d1	D	L	H [OPEN]	Wts.-kg [APPROX.]
1/2"	10.00	95.0	152.00	61.0	3.2
3/4"	13.00	117.0	178.00	63.0	4.4
1"	17.50	125.0	203.00	78.0	6.1
1-1/4"	28.00	133.0	216.00	82.0	12.0
1-1/2"	28.00	155.0	229.00	88.0	12.2
2"	36.00	165.0	267.00	108.0	16.4

DESIGN DESCRIPTION	STANDARD
Integral Flanged Body.	Steel Valves : ASME B16.34
Bolted Cover	Face to Face : JIS B 2002
Horizontal Piston Type	End Flanges : JIS B 2210
Integral Seat	Pressure Test : JIS B 2003